

# SNUBBER

## MODEL X5.03



### PRODUCT DESCRIPTION

A pressure gauge snubber is a device used to suppress excess force or rapid movement in mechanical systems. Pressure snubbers are designed to dampen the effect of pressure pulses and spikes to assure longer service life and readability of pressure gauges in harsh applications. Pressure snubbers protect pressure gauges from the harmful effects of vibrations generated in a pressurized system with pulsations such as positive displacement pumps or compressors. The use of a snubber in pressure gauge applications does not alter the process pressure, it will reduce pulsations on the line, thus improving the accuracy of gauge readings, and extending the life of that specific gauge.



# SNUBBER

# MODEL X5.03

## KEY FEATURES

- Designed to reduce dampening effect of process fluid
- Working Pressure up to 400 kg/cm<sup>2</sup>
- Working Temperature up to 120°C
- All stainless steel construction
- For corrosive environment & media
- Adjustable Needle Design

## SPECIFICATIONS

Max. Working Temp. : -20°C to 120 °C  
Max. Working Pressure : Up to 400 kg/cm<sup>2</sup>  
Instrument Connection : ½" NPT (F)  
Process Connection : ½" NPT (M)

## APPLICATION

- Pumps
- Hydraulic Machines
- Compressors
- Process plants
- Non crystallized liquid

## MATERIAL OF CONSTRUCTION

Body : SS 316  
Sealing 'O' Ring (Internal) : Viton

## DIMENSIONAL DRAWINGS

### Guage Snubber

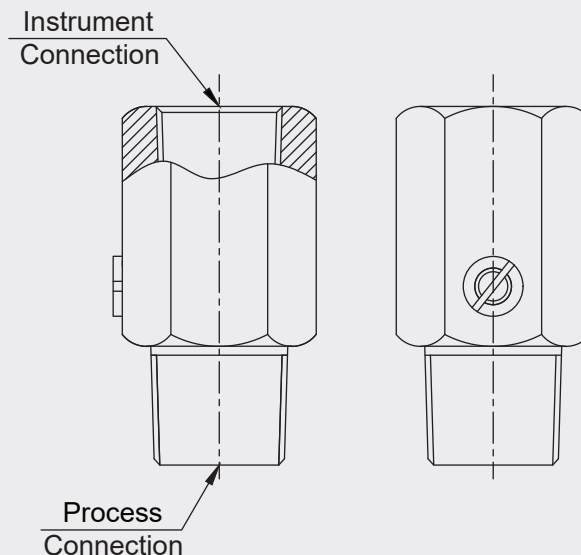

Important Notes: Above drawings are not to scale. All Dimension are in mm

# SNUBBER

# MODEL X5.03

## MODEL CODING & ORDERING INFORMATION

DESCRIPTION	CODE	X5.03	A	S4	14NM.14NF	X17
<b>Model</b> Snubber	X5.03	X5.03				
<b>Version</b> Adjustable Needle	A		A			
<b>Body Material</b> SS 304	S4			S4		
SS 316	S6					
SS 316L	SL					
SS 316 / SS 316L	DC					
Inconel 625	I5					
Inconel 825	I2					
Monel 400	M4					
Hast C-276	HC					
<b>Connection</b> 1/4" BSP (M x F)	14BM.14BF					
1/4" BSP (M x M)	14BM.14BM					
3/8" BSP (M x F)	38BM.38BF					
3/8" BSP (M x M)	38BM.38BM					
1/2" BSP (M x F)	12BM.12BF					
1/2" BSP (M x M)	12BM.12BM					
1/4" NPT (M x F)	14NM.14NF				14NM.14NF	
1/4" NPT (M x M)	14NM.14NM					
3/8" NPT (M x F)	38NM.38NF					
3/8" NPT (M x M)	38NM.38NM					
1/2" NPT (M x F)	12NM.12NF					
1/2" NPT (M x M)	12NM.12NM					
M20 x 1.5 (M x F)	M20M.M20F					
<b>Other Options</b> Material test certificate	X17					X17
Tested to NACE Standard	X20					
Oxygen Service	X21					

## SAMPLE ORDERING CODE:

**X5.03-A.S4.14NM.14NF.X17**

Note: Specifications and dimensions given in this product catalogue represents the state of engineering at the time of printing. Modifications may take place and material specified may be replaced by others without prior notice.