

MAGNETIC LEVEL GAUGE

MODEL M4.01

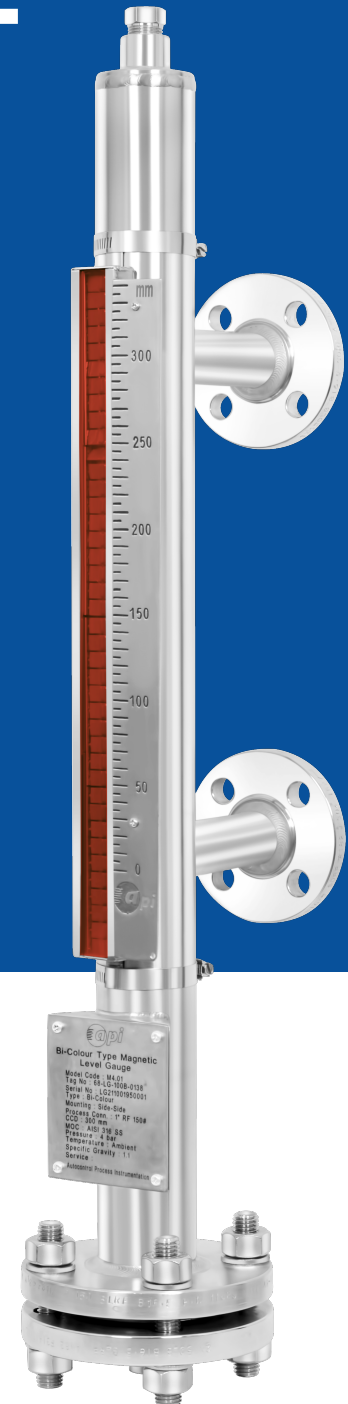

PRODUCT DESCRIPTION

Magnetic Level gauges provides clear, high clarity indication of liquid level. Magnetic float level sensors involve the use of a permanent magnet sealed inside a float whose rise and fall causes the opening or closing of a mechanical switch, either through direct contact or in proximity of a reed switch. With mechanically actuated floats, the float is directly connected to a micro switch.



MAGNETIC LEVEL GAUGE

MODEL M4.01

KEY FEATURES

- External Mounting
- Hassel free installation
- Side-Side /Top/Side bottom mountable
- Bi-color flag indicator with optional point level
- Switches or transmitter output
- Transmitter output 4-20mA

SPECIFICATIONS

Specific Gravity	: 0.6 (Min.)
Working Pressure	: 10...100 bar
Working Temp.	: -20...400 °C
C-C Distance	: 200mm to 5000mm
Process Connection	: Flanged & Screwed
Indicator	: Red & White

APPLICATION

- Oil & Water storage tank
- Chemical & Fertilizer plants
- Pharmaceutical & beverages plants
- Processing tanks & Underground Storage tanks

MATERIAL OF CONSTRUCTION

Chamber Size	: 2" /2 ½" /3"
Pipe Schedule	: Sch. 10 pipe up to Sch. 160
Float	: SS 316
Scale	: Aluminum / SS 304 / SS 316
Resolution	: 5 mm
Indicator Roller	: Metallic

MAGNETIC LEVEL GAUGE

MODEL M4.01

DIMENSIONAL DRAWINGS

Magnetic Level Gauge
(Side-side)

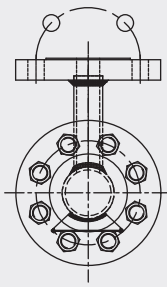

TOP VIEW

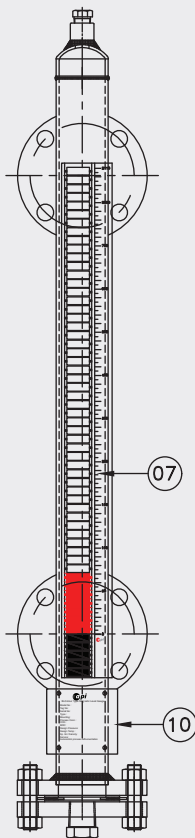

FRONT VIEW

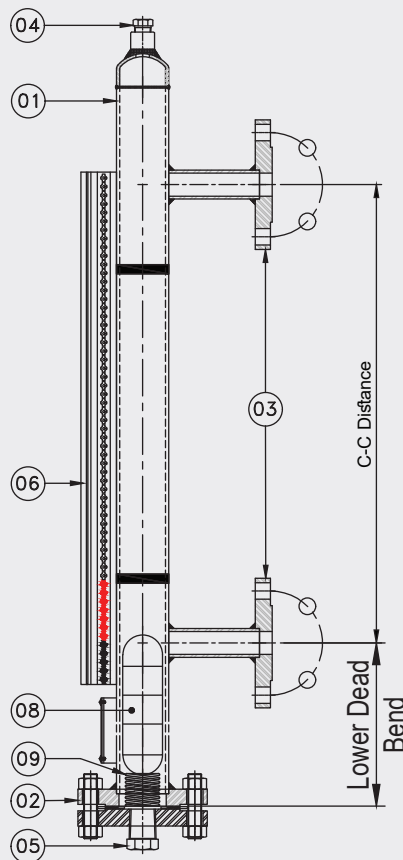

SIDE VIEW

Bill of Material	
Sr.No.	Parameter
01	Chamber Pipe
02	Chamber Flange
03	Process Connection
04	Vent Connection
05	Drain Connection
06	Indicator System
07	Scale
08	Magnetic Float
09	Spring
10	Tag Plate

Important Notes: • Above drawings are not to scale • All Dimension are in mm



MAGNETIC LEVEL GAUGE

MODEL M4.01

DIMENSIONAL DRAWINGS

Magnetic Level Gauge
(Side-Side with GRW Transmitter)

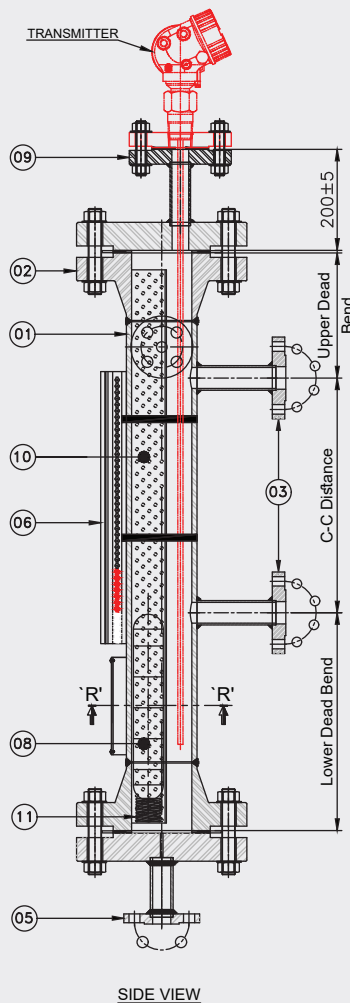
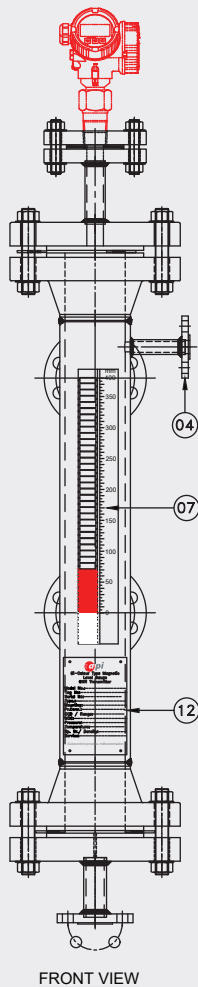
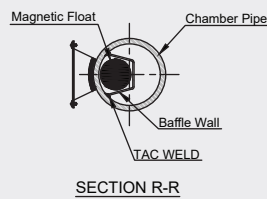
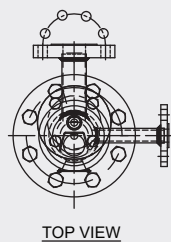

Bill of Material	
Sr.No.	Parameter
01	Chamber Pipe
02	Chamber Flange
03	Process Connection
04	Vent Connection
05	Drain Connection
06	Indicator System
07	Scale
08	Magnetic Float
09	Instruments Connection
10	Baffle Wall
11	Spring
12	Tag Plate

Important Notes: • Above drawings are not to scale • All Dimension are in mm

MAGNETIC LEVEL GAUGE

MODEL
M4.01

DIMENSIONAL DRAWINGS

Magnetic Level Gauge
(Side-Bottom)

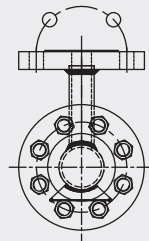

TOP VIEW

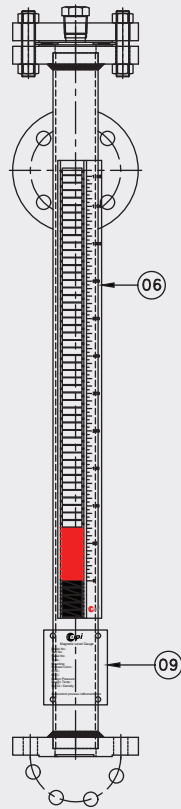

FRONT VIEW

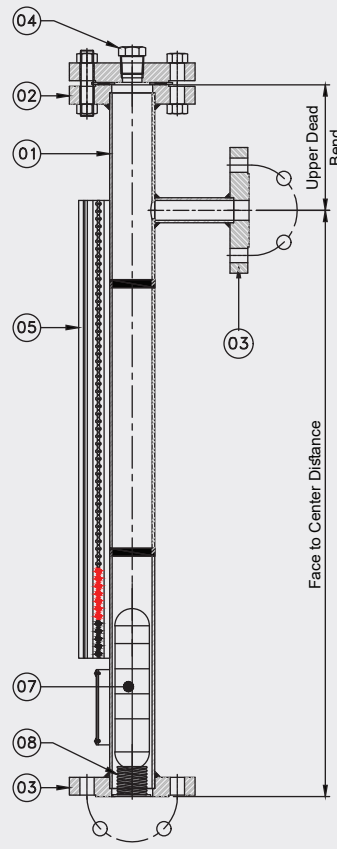

SIDE VIEW

Bill of Material	
Sr.No.	Parameter
01	Chamber Pipe
02	Chamber Flange
03	Process Connection
04	Vent Connection
05	Indicator System
06	Scale
07	Magnetic Float
08	Spring
09	Tag Plate

Important Notes: • Above drawings are not to scale • All Dimension are in mm



MAGNETIC LEVEL GAUGE

MODEL
M4.01

DIMENSIONAL DRAWINGS

Magnetic Level Gauge
(Top)

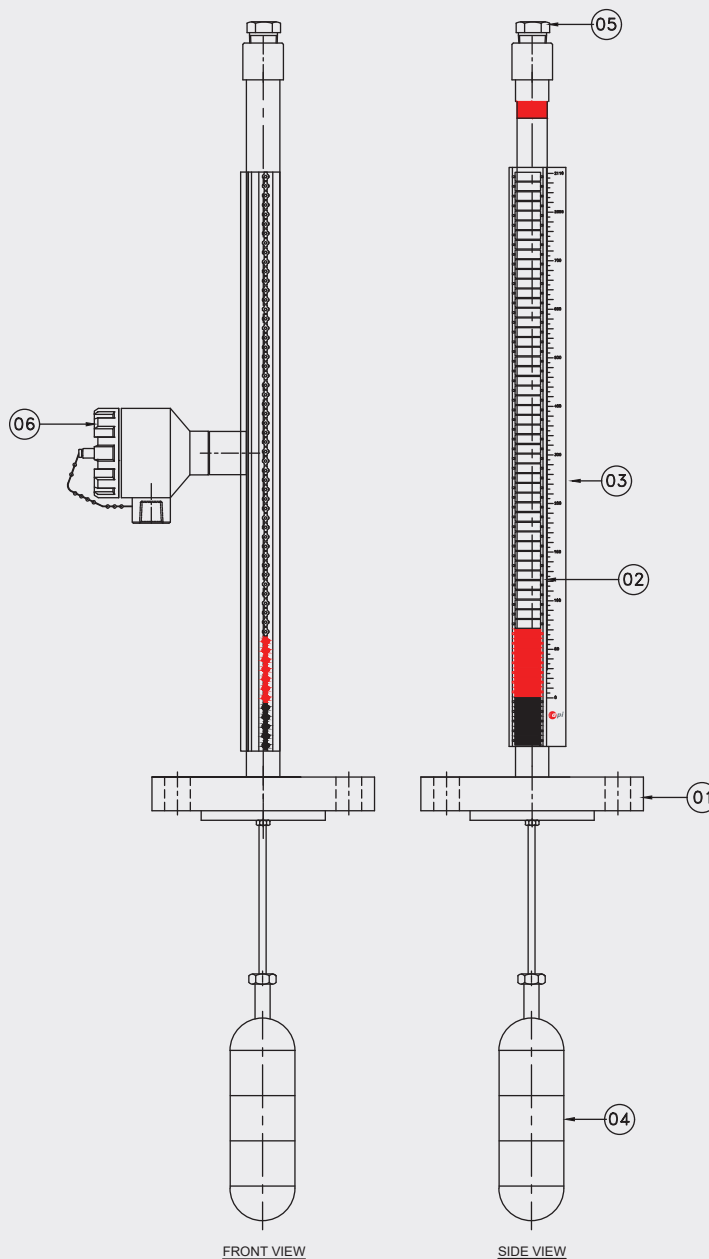

Bill of Material	
Sr.No.	Parameter
01	Process connection
02	Indicator System
03	Scale
04	Float
05	Vent Connection
06	Level switch

Important Notes: • Above drawings are not to scale • All Dimension are in mm

MAGNETIC LEVEL GAUGE

MODEL M4.01

MODEL CODING & ORDERING INFORMATION

DESCRIPTION	CODE	M4.01	1	S6	S4	S6	AL	12NM	12NF	12NF	WP	DP
Model												
Magnetic Level Gauge	M4.01	M4.01										
Mounting												
Side-Side Mounted	1		1									
Top Mounted	2											
Side-Bottom Mounted	3											
Wetted Parts												
SS 304	S4											
SS 316	S6			S6								
SS 316L	SL											
SS 316 / SS 316L	DC											
Inconel 625	I5											
Duplex SS 2205	DU											
PVC	PV											
PVDF	PD											
Polypropylene	PP											
Titanium	TI											
Float												
SS 304	S4				S4							
SS 316	S6											
SS 316L	SL											
Inconel 625	I5											
Inconel 825	I2											
Hast C-276	HC											
PVC	PV											
PVDF	PD											
Polypropylene	PP											
Titanium	TI											
Baffle Valve												
SS 304	S4											
SS 316	S6					S6						
SS 316L	SL											
SS 316 / SS 316L	DC											
Inconel 625	I5											
Inconel 825	I2											
Duplex SS 2205	DU											
None	XX											
Material of scale												
Aluminum	AL						AL					
SS 304	S4											
SS 316	S6											
Acrylic	AC											
Process Connection (Size & Type)												
½" NPT (M)	12NM							12NM				
¾" NPT (M)	34NM											
1" NPT (M)	25NM											
2" NPT (M)	50NM											
Flange Connection Refer Table '1'	XXX											
Vent Connection												
½" NPT (F)	12NF								12NF			
¾" NPT (F)	34NF											
Flange Connection Refer Table '1'	XXX											
Drain Connection												
½" NPT (F)	12NF									12NF		
¾" NPT (F)	34NF											
Flange Connection Refer Table '1'	XXX											
Top Side Vent												
Welded Top End Cap + Plug ½" NPT (M)	WP										WP	
Welded Top End Cap + Valve ½" NPT (F)	WV											
Customized Design (Non-Standard)	XX											
Bottom Side Vent												
Dual Flange + Plug ½" NPT (M)	DP											DP
Dual Flange + Valve ½" NPT (F)	DV											
Single Flanged (For Top Mounted)	SP											
Customized Design (Non-Standard)	XX											

MAGNETIC LEVEL GAUGE

MODEL M4.01

MODEL CODING & ORDERING INFORMATION

DESCRIPTION	CODE	P1	T1	WR	K1	ST1	XXX	T4	CS	L06	T1	X17
Pressure Range												
0 to 3 kg/cm ²	P1	P1										
0 to 10 kg/cm ²	P2											
0 to 25 kg/cm ²	P3											
0 to 50 kg/cm ²	P4											
0 to 100 kg/cm ²	P5											
Temp. Range												
0 to 80°C	T1		T1									
-20 to 120°C	T2											
-20 to 400°C	T3											
Indicator												
White + Red	WR			WR								
White + Yellow	WY											
Switch Type												
SPST (Reed Switch)	K1				K1							
SPDT (Micro Switch)	K2											
DPDT (Micro Switch)	K3											
No. of switches												
One	ST1					ST1						
Two	ST2											
Three	ST3											
Four	ST4											
Center to Center Distance												
As per customer requirements	XXX						XXX					
Transmitter												
Transmitter with 4-20mA Output	T4							T4				
Steel Well (For Top Mounting)												
Carbon Steel	CS								CS			
SS 304	S4											
SS 316	S6											
Other Variants												
Indicator + Switch	L06									L06		
Indicator + Transmitter	L07											
Indicator + Switch + Transmitter	L08											
Switching Point												
As per customer requirement	T1										T1	
Other Options												
Material Test Certificate	X17											X17
IBR Certification	X18											
Tested to NACE Standard	X20											
SS Tag Plates	X26											
Float Failure Indication-50mm (Yellow + White)	X71											
Plug/Counter Flange for Vent	X93											
Needle valve in Drain	X94											
Ball valve in Drain	X95											
Performance Test Certificate	X96											
Hydrostatic Test Certificate	X97											
NDT Test	X100											

MAGNETIC LEVEL GAUGE

MODEL M4.01

Table -1 (Flange Connection) AS PER ANSI B 16.5

NOMINAL SIZE	RATING/ CLASS	CODE	NOMINAL SIZE	RATING/ CLASS	CODE	NOMINAL SIZE	RATING/ CLASS	CODE	NOMINAL SIZE	RATING/ CLASS	CODE
1/2"	150	B09	1"	150	B21	1 1/2"	150	B33	2 1/2"	150	B45
	300	B10		300	B22		300	B34		300	B46
	600	B11		600	B23		600	B35		600	B47
	900	B12		900	B24		900	B36		900	B48
	1500	B13		1500	B25		1500	B37		1500	B49
	2500	B14		2500	B26		2500	B38		2500	B50
3/4"	150	B15	1 1/4"	150	B27	2"	150	B39	3"	150	B51
	300	B16		300	B28		300	B40		300	B52
	600	B17		600	B29		600	B41		600	B53
	900	B18		900	B30		900	B42		900	B54
	1500	B19		1500	B31		1500	B43		1500	B55
	2500	B20		2500	B32		2500	B44		2500	B56

SAMPLE ORDERING CODE:

M4.01-1.S6.S4.S6.AL.12NM.12NF.12NF.WP.DP.P1.T1.WR.K1.ST1.XXX.T4.CS.L06.T1.X17

Note: Specifications and dimensions given in this product catalogue represents the state of engineering at the time of printing. Modifications may take place and material specified may be replaced by others without prior notice.